

MTD-5

MTD-5-SW

Maße für SW-Ausführung in Klammern
SW-Dimensions in brackets

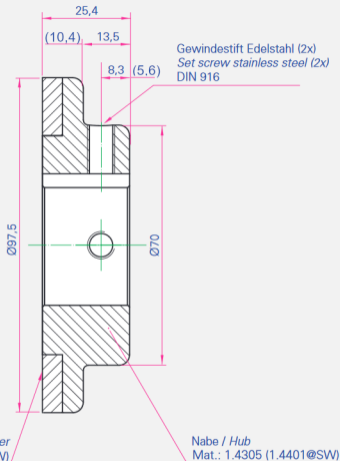
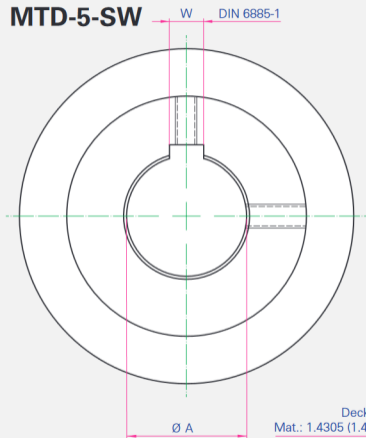

Technische Daten

Technical Specifications

| Typ Type | Max. Geschw Speed (rpm) | Gewicht pro Hälfte Weight per Hub (kg) |
|-------------|-------------------------------|--|
| MTD-5 | 11000 | 1,1 |

| Typ Type | Bohrung Bore Ø A (mm) | Passfeder Keyway W (mm) | Gewindestift Set Screw |
|-------------|-----------------------------|-------------------------------|---------------------------|
| MTD-5-11 | 11H7 | 4 | M5 |
| MTD-5-12 | 12H7 | 4 | M5 |
| MTD-5-14 | 14H7 | 5 | M5 |
| MTD-5-16 | 16H7 | 5 | M5 |
| MTD-5-18 | 18H7 | 6 | M5 |
| MTD-5-20 | 20H7 | 6 | M5 |
| MTD-5-22 | 22H7 | 6 | M5 |
| MTD-5-25 | 25H7 | 8 | M5 |
| MTD-5-30 | 30H7 | 8 | M5 |
| MTD-5-35 | 35H7 | 10 | M5 |